

CASE STUDY - Traditional Style Staircase – Brize Norton

Our client was a property developer converting an old Barn into a modern open-plan house. We had to create a staircase that was traditional in structure, matching the barn's solid Oak beams, but contemporary in design to reflect the open feel to the property. In addition to the staircase, we had to create an elevated walkway which would be decked in the same timber as the staircase had have matching balustrade. The staircase was manufactured in Oak and had glass infill panels held in place by stainless steel brackets. The result created a stunning entry piece for the new property that enhanced the overall feel of its surroundings.

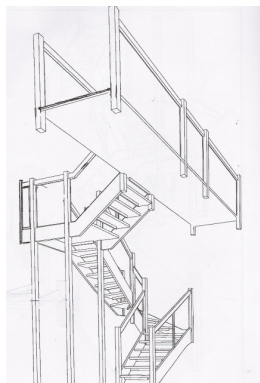
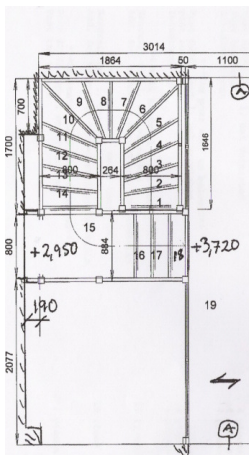

TECHNICAL SPECIFICATION

FLOOR TO FLOOR HEIGHT	-	3720mm
RISERS	-	15 @ 196.6mm & 4 @ 192.5mm
GOING	-	225mm
CLEAR TREAD WIDTH	-	800mm
TREADS	-	42mm Solid Oak
STRINGERS	-	42mm Solid Oak
NEWEL POSTS	-	80 x 80mm Oak (no. 1 in range)
HANDRAIL	-	no. 1 in range – Solid Oak
BALUSTRADE INFILL	-	8mm toughened glass panels
WALKWAY	-	4577 x 1100mm Solid Oak



01794 522 444

www.completestairsystems.co.uk
info@completestairsystems.co.uk