

CASE STUDY - Traditional Style Staircase, Rickmansworth, Herts

Our customer needed a staircase at the end of a large, central hallway for their new build property. The hall was finished with a full-length glass window, so an impressive looking model was required as it would be fully visible from outside. The Traditional Style Staircase in Oiled Oak, with a customised arrangement of winder treads for the initial tight headroom turn, was the perfect solution, allowing the light to pass through into the hallway, whilst still protecting the window with a small run of external balustrade. The riser bars were customised by the customer from extra spindles we supplied.

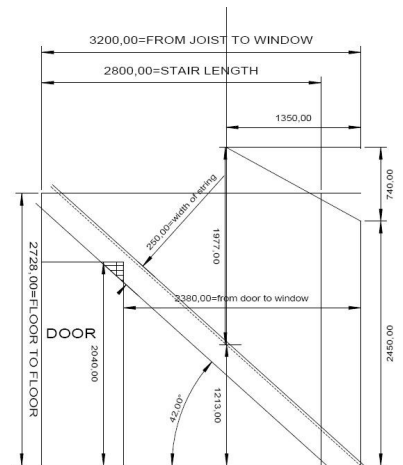
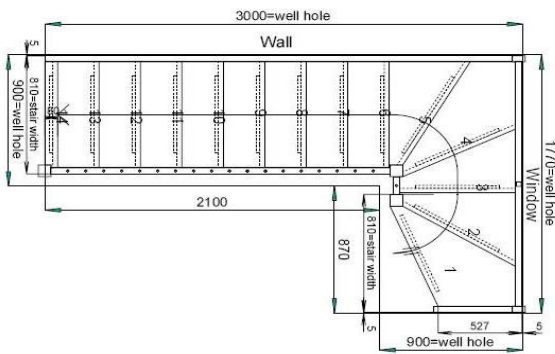

TECHNICAL SPECIFICATION

FLOOR TO FLOOR HEIGHT	-	2728mm
RISERS	-	14 @ 194.9mm
GOING	-	260mm
TREAD WIDTH	-	810mm
TREADS	-	42mm Solid Oiled Oak
STRINGERS	-	42mm Solid Oiled Oak
NEWEL POSTS	-	80 x 80mm Oiled Oak
HANDRAIL	-	42 x 80mm Oiled Oak (no. 5)