

CASE STUDY – Straight Flight Fire Escape – Hotel, Shropshire

Our client was undertaking some refurbishment work for a hotel chain in Shropshire. We had to replace a disintegrating existing timber fire escape had become a danger to use. Because of its location we had to introduce some large platforms between two walls and as there was a door at the ground floor level we had to carefully design the lower stair so that it did not create any headroom problems. The decking was manufactured in non slip perforated steel and the balustrade on both the spiral and the straight flight was made up of vertical steel spindles. The staircase was fully galvanised to ensure it lasted longer than the timber stair it was replacing

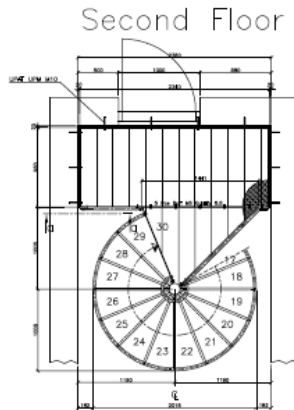

TECHNICAL SPECIFICATION

FLOOR TO FLOOR HEIGHT	-	3010mm & 2800mm
RISERS	-	16 @ 188.1mm & 14 @ 200mm
CLEAR TREAD WIDTH	-	800mm
DIAMETER	-	2016mm
TREADS	-	Non Slip Perforated Steel
CENTRE COLUMN	-	139.7mm Ø
STRINGER	-	140 x 8mm
VERTICAL BALUSTERS	-	33.7mm Ø
HANDRAIL	-	33.7mm Ø
BALUSTRADE INFILL	-	10mm Ø Spindles
FINISH	-	Fully Galvanised

