

CASE STUDY - Bespoke Spiral Staircase – Office, Hackbridge, Surrey

Our client was a shoe manufacturer extending their existing office / factory in Hackbridge in Surrey and needed a spiral to provide access to a new mezzanine floor. Our brief was to create a stylish functional spiral staircase whilst matching the Beechwood flooring being fitted elsewhere in the building. We decided on beechwood treads supported by a powder coated steel structure, topped with a stainless steel handrail which we continued around the stairwell opening. As this was a commercial installation we included a handrail on the centre column

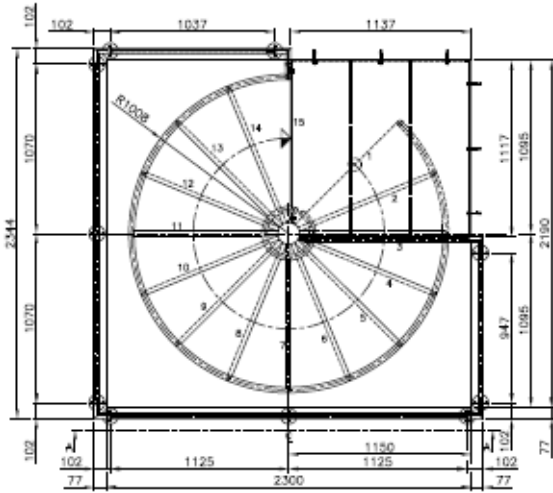

TECHNICAL SPECIFICATION

| | | |
|-----------------------|---|--------------------------|
| FLOOR TO FLOOR HEIGHT | - | 2932mm |
| RISERS | - | 15 @ 195.5mm |
| CLEAR TREAD WIDTH | - | 800mm |
| DIAMETER | - | 2016mm |
| TREADS | - | 30mm Solid Beech |
| CENTRE COLUMN | - | 139.7mm Ø |
| VERTICAL BALUSTERS | - | 33.7mm Ø |
| HANDRAIL | - | 33.7mm Ø |
| BALUSTRADE INFILL | - | 10mm Ø Vertical Spindles |
| FINISH | - | Powder Coated – RAL 9006 |

